

Reassurance
through understanding
Clean energy

LP Gas

Publicity pamphlet for household users



For household users of LPG

LPガス
人と地球にスマイルを
October 10th is LP Gas Day!

Please read through this pamphlet with everyone in your family.
This pamphlet is provided to households as required by the LPG Law.

- Name of dealer: Hosoyachi Co., Ltd.
- Address: 17-100-10 Osanai-cho, Kuji City, Iwate Prefecture
- Tel. No.: 0194-53-2305
- Tel. No. for emergencies: Weekdays/Daytime: 0194-53-2305
Sundays/Nighttime: 048-430-7646

一般社団法人 岩手県高圧ガス保安協会

In case of emergency

Be safe at all times



Earthquakes

Don't panic. After the shaking stops, then completely extinguish flames by closing all gas and appliance valves. If the shaking is strong, also close the outdoor LPG cylinder valves.

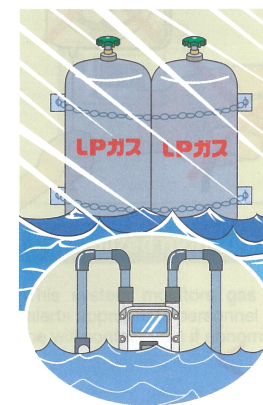

Preparations for typhoons and flooding

If you have any concerns about the gas cylinder at your home (such as cylinder wobbling), please contact an LP gas salesperson.

If the cylinder or LP gas equipment becomes inundated in a flood or falls over, please notify the LP gas dealer or safety organization.

Cylinder valve

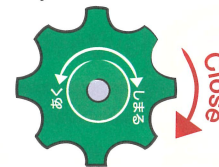

How to close the gas cylinder valve

Be sure to close all gas valves as well as the valves of any gas cylinders if you evacuate your home. Turn the valve clockwise to close it.

※Do not begin using LPG again until your LPG dealer or safety organization has conducted an inspection.



Safety measures in regions with heavy snowfall

- **Erect a snow fence or cylinder shed**
Snow fences or cylinder sheds can be used to prevent gas cylinders from being buried in the snow and to protect the regulator, piping and meter from snow that was shoveled or slid off a roof. Be sure to clear snow from such fences and cylinder sheds.
- **Shovel snow carefully**
Be careful not to damage gas equipment when clearing away snow.
- **Reinforce exhaust ducts (chimneys)**
Braces should be added to reinforce exhaust ducts.

How to restart the microcomputer meter

Push and immediately release the reset button on the microcomputer meter. Then wait at least one minute.

Turn off appliances, make sure unused gas valves are completely shut, then press the reset button. The red light and LCD will start blinking. Wait about 1 minute for the microcomputer meter to check for LPG leak. If there is no problem, the red light will stop blinking and the LCD message goes off. This completes the recovery process, so you can open the valves and begin using the LPG. (If the reset fails, do not try this process again, contact your LPG dealer and have it checked by a professional.)

※Some microcomputer meters have a cap over the reset button.

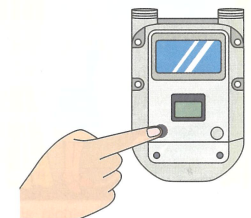

For your safe and

Please be a responsible user and check on the safety of your gas appliances daily.

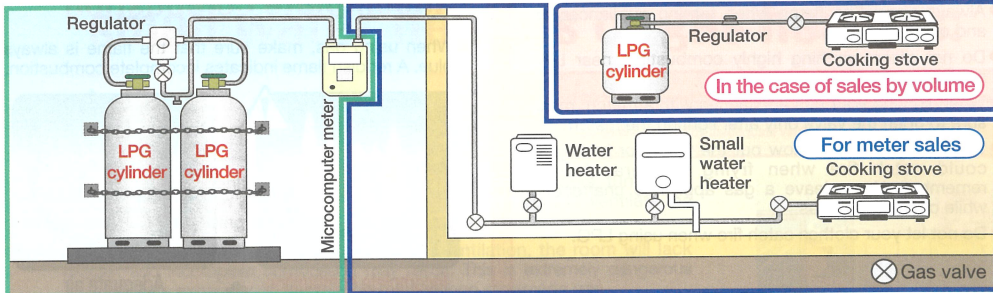

Safely managed by LPG dealer
Supplier equipment

Safely managed by consumer
Consumer equipment

What is supplier equipment?

Supplier equipment ranges from LPG cylinders to microcomputer meters, and their safety is the responsibility of the LPG dealer.

What is consumer equipment?

Consumers are legally responsible for consumer equipment that normally ranges from the microcomputer meter outlet to the gas appliances themselves (from the LPG cylinder to gas appliances when no gas meter is present).

Please cooperate with inspections and surveys for your safety.

For your safety and peace of mind, an authorized LPG dealer or safety organization requested by the dealer will conduct the following periodic safety inspections as required by the Liquefied Petroleum Gas Law.

① When a gas cylinder is replaced

Inspection of the LPG cylinder, regulator, cylinder valve and gas piping.

② At least once a year

Inspection of piping and appliances to check for gas leaks in basements and other problems.

③ Ideally at least once every 4 years

General inspection of gas appliances such as functional inspection of gas regulators, inspection for gas leaks from piping and inspection of gas appliances and intake/exhaust equipments.

※Appliance repairs are legally required if the inspection determines they are necessary.

LPG characteristics

① Heavier than air

Since LPG is heavier than air, be sure to ventilate low areas to expel the gas outdoors if you discover a gas leak.

② Special odor

LPG is naturally colorless and odorless but to make leaks easier to detect, an artificial gaseous odor (an offensive odor) is intentionally added.

③ Combustion requires air

Proper combustion of LPG requires air (oxygen). Please be sure to ventilate the room when using LPG indoors, inadequate ventilation causes incomplete gas combustion that contains carbon monoxide. Always make sure that the area around your gas appliance is thoroughly ventilated.

comfortable use of LPG



Check when using LPG.

- Be sure to use appliances made for use with LPG.
City gas appliances cannot be used with LPG.
- Be sure to read instruction manuals thoroughly and use LPG appliances properly.

Before using a new gas appliance, always check that it is designed for use with LPG.

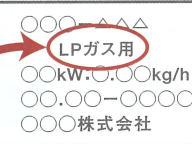

Manufacturer's label

※LPG appliances have the above label information.

Gas appliances have limited lifespans.
Have them inspected or replaced after using them for 10 years.



Handling of small LPG cylinders

- Set the cylinder on a flat and level surface so that it cannot tip over.
- Do not set the cylinder in direct sunlight or near flame sources.
- Be sure to close the cylinder valve after using it.
- Store cylinders in a well-ventilated area away from potential fire hazards.
- Be sure to return used cylinders to your LPG dealer.



Small cylinder



Contact your LPG dealer in any of the following circumstances.

(See contact information on front cover)

- Before installing or removing gas equipment or gas appliances.
- Before starting or stopping use of LPG when building a new house, remodeling a house or when moving house.
- When it is difficult to set up or put away seasonal gas appliances such as gas heaters.
- Before starting to use a gas appliance that was not used for a long time.
- If the cylinder or LP gas equipment becomes inundated with water in a disaster such as a typhoon or flood.
- If the cylinder falls over.

※Remember that anyone performing work related to piping, bathtub water heaters, small water heaters or exhaust ducts must be legally qualified.

※Remember that some bathtub water heaters and small water heaters require intake and exhaust outlets.

- Accidents resulting in gas pipe damage have occurred during construction not directly related to gas, such as work related to remodeling, painting, or the water supply. Always contact your LPG dealer when doing any construction not directly related to gas.

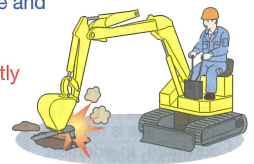

Use LPG correctly to be safe at all times.

Precautions when cooking

- Always check the flame when turning appliances on and off.
- Do not place anything highly combustible near LPG appliances.
- When lighting your gas appliances with a match, make sure to open the valve only after lighting the match.
- Wind or spills could blow out the flame, or boiling oil could catch fire when frying tempura. Always remember: Never leave a gas appliance unattended while cooking with gas.
- Do not let your clothes catch fire when using LPG.

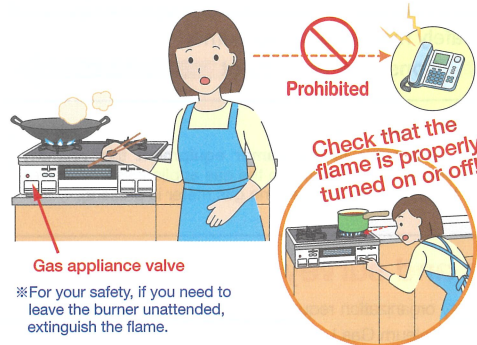

Precautions to prevent incomplete combustion

- When using gas, make sure that the flame is always blue. A reddish flame indicates incomplete combustion.

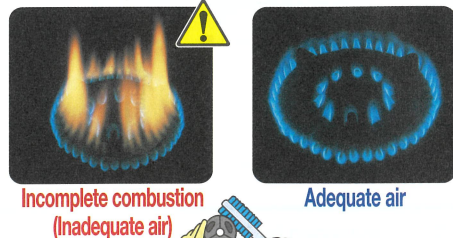

Maintaining your LPG appliances

LPG appliances that are clogged may cause incomplete combustion, so brush them clean occasionally. If maintenance of gas appliances such as burners requires removing screws or other parts, contact your LPG dealer and never perform the maintenance yourself.

Precautions when connecting gas appliances

- Use a rubber hose made for your LPG gas valve or a compatible hose.
- To prevent gas leaks, it is prohibited to use a rubber hose to connect a fixed-type appliance such as a water heater or bathtub water heater with a gas valve.
- Do not use excessively long rubber hoses. (The hoses of 3 meters or less are preferable.)
- Make sure that rubber hoses are inserted up to the red line on gas valves and fasten them tightly in place with hose clamps.
- Do not bend rubber hoses sharply or force them through tight spaces.
- Never use three-way union connectors as they are dangerous.
- Occasionally check rubber hoses and do not use them if they are cracked or burnt. Check rubber hoses for gas leaks by putting some soapy water on them and looking for bubbles. If you notice any bubbles, replace the hoses immediately. Be sure to wipe off the hoses after checking.

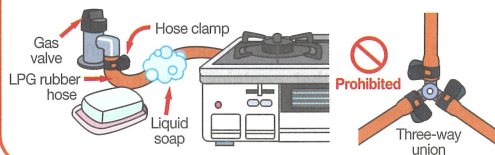

Precautions for using gas valves

- When using gas, open gas valves completely. When not using gas, close gas valves completely.
- Before going out or going to bed, be sure to close gas and appliance valves.
- Do not use gas piping or valves to ground electrical appliances.
- Never open a gas valve that is not connected to a stove or other gas appliance. (Attaching a gas tap cover and rubber cap is recommended when leaving the gas appliance unattended.)

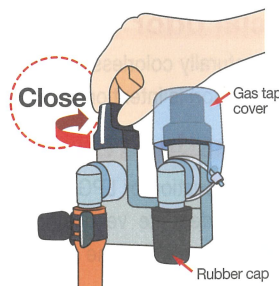

To consumers using appliances such as small water heaters or gas heaters:

Always maintain thorough intake and outtake ventilation.

※CO (carbon monoxide) is a colorless, odorless and extremely toxic gas.
 ※There have been cases of fatal accidents due to CO (carbon monoxide) poisoning caused by inadequate ventilation.

- To ensure proper ventilation when using LPG appliances indoors, turn on an exhaust fan or open a window occasionally. (Do not forget to ventilate the room air when heating and cooling.)
- ※Burning gas requires air. Without adequate ventilation, the room will lack oxygen and incomplete combustion may result. This is extremely dangerous because gas exhaust can contain harmful carbon monoxide gas.
- ※If an appliance's flame goes out after igniting or during use, a safety device may have been activated. Stop using the appliance immediately without trying to relight it and use the emergency number on the front cover to contact your gas appliance dealer, LPG dealer or safety organization. (See contact information on front cover.)

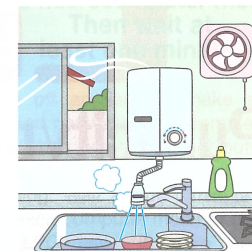

- Check whether the fins are clogged with dust.
- Never use a small water heater to fill a bath or as a shower.

The fins are here.

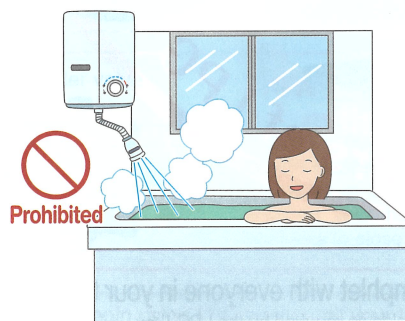
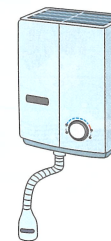

To consumers using bathtub water heaters with natural exhaust systems:

- Do not use the ventilation fan when using gas for a bathtub with a chimney spout natural ventilation system. Exhaust gas may be sucked back inside and cause CO (carbon monoxide) poisoning.

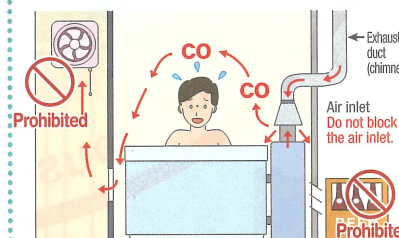

- Also, if exhaust ducts are damaged or blocked (e.g., by a bird's nest), adequate ventilation is not possible. Check the condition of the ducts occasionally.

Upon request, we will inspect gas appliances for CO (carbon monoxide) emissions. If abnormal CO (carbon monoxide) emissions are found, the defective gas appliances should be replaced immediately. Please replace gas appliances that become too old or are not equipped with an incomplete combustion detector without delay.

When using a gas alarm

- Check that the alarm unit is mounted in an appropriate position.
- Keep the power cord of the alarm unit plugged into the outlet at all times. If the alarm goes off, never unplug the unit until you identify the cause of the alarm.
- Do not place anything around the alarm unit.
- Check that the replacement date for the alarm unit has not expired.
- ※As a general rule, shared housing, schools, hospitals, and other high occupancy facilities, underground rooms, and other facilities with fire equipment are required by law to install LPG alarms.

In case of gas leak!!

[If you smell gas] [If your gas alarm sounds]

<Never ignite anything.>

- Extinguish any fire in the room.
- Do not touch an electric outlet or any switch. It might cause a spark and ignite the gas.

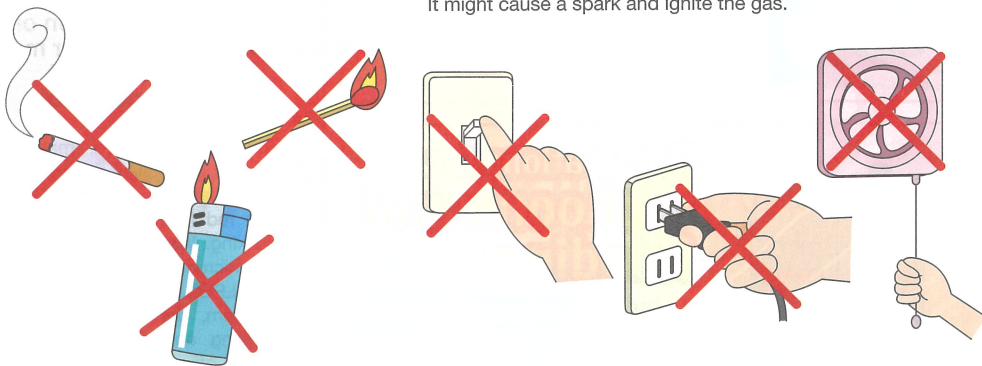

<Ventilate the room.>

- Fully open doors and windows in the room.
- Shut all gas valves and turn off all LPG appliances.
- Close the main valve on the gas cylinder.

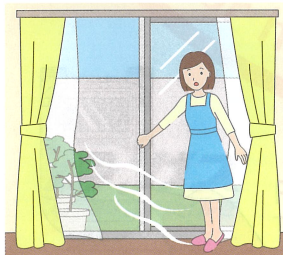

※LPG is heavier than air. Be aware that LPG can accumulate at floor level.

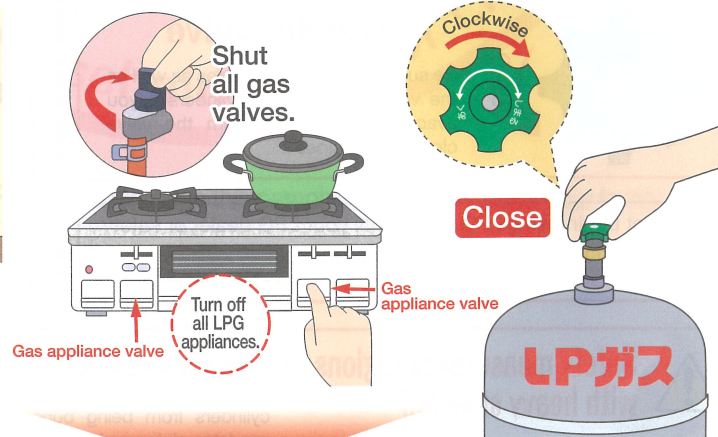

<Contact your LPG dealer or safety organization. (See emergency number on front cover.)>

- Tell the dealer or safety organization your name, address and describe the problem.
- Do not begin using LPG again until your LPG dealer or safety organization has conducted an inspection.
- ※Contact them in the event of any LPG-related accident.

See contact information on front cover.

We recommend LPG appliances with safety equipment or safety devices.

Microcomputer meters

If a gas leak or other abnormality in gas flow/pressure occurs, the microcomputer meter automatically shuts off the gas supply.

※The microcomputer meter is equipped with a safety function that shuts off the gas supply if a major earthquake (magnitude 5 and larger) occurs.

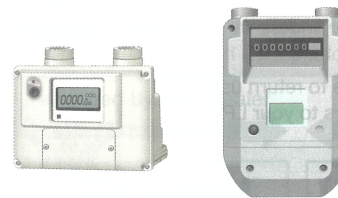

Centralized monitoring system

This system monitors gas usage 24/365 and alerts appropriate personnel (such as a dealer so he will contact you) if abnormalities are detected.

Si sensor portable cooking stove



A gas stove equipped with safety sensors on all burners that detect flame out, overheated cooking oil, and unattended flames.

- ◆ The flame-out sensor automatically stops gas flow if a spill, boiling over, strong winds, etc. extinguishes the flame.
- ◆ To prevent cooking oil combustion, the overheated cooking oil sensor monitors the temperature on the bottom of the pot and automatically extinguishes the flame if the temperature reaches 250°C.
- ◆ The lighted flame sensor automatically extinguishes the flame if left on for a certain period of time.

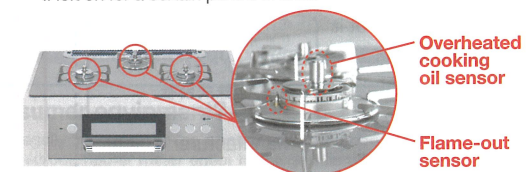

Gas alarm

This alarm unit senses a gas leak promptly and sounds a warning with a buzzer or voice message.



Effectively prevents CO (carbon monoxide) poisoning

CO (carbon monoxide) alarm

This alarm detects CO (carbon monoxide) emitted by incomplete combustion and sounds a warning with a buzzer or voice message.



Small water heaters with incomplete combustion prevention systems

Gas is shut off automatically when incomplete combustion occurs.

※Small water heaters without the above system may cause CO (carbon monoxide) poisoning through incomplete combustion. Early replacement is highly recommended.



Outdoor water heaters

Outdoor installation effectively prevents CO (carbon monoxide) poisoning since ample ventilation is available for combustion and the exhaust gas is released outdoors. In addition, excellent in energy-saving performance.



It is safer to use residential fire alarms and CO (carbon monoxide) alarms equipped with a gas alarm.

Residential fire/gas/CO alarm

This system sounds a warning with a buzzer or voice message if it detects a fire, CO (carbon monoxide), or a gas leak.

